



# THE HH36 SERIES

## SPIRAL DESIGN – SWINGHAMMER HOG

### Energy Efficient Rotor

The Montgomery Hammer Hog incorporates several unique design features not found in other swinghammer hogs used for coarse grinding of heavy bark tonnages and other solid wastes.



## Overview:

### Applications

- Bark for Fuel or Mulch
- Gypsum Rock
- Industrial Trash
- Municipal Refuse

### Operating Features

- Spiral rotor design assures constant impacting with material being processed. High processing rates are attainable with lower horsepower requirements.
- Unique locking device holds hammers in extended centrifugal position to create a balanced rotor effect which reduces starting load on motor. A distinct benefit for maintenance personnel when servicing the rotor.



# THE HH36 SERIES

## SPIRAL DESIGN – SWINGHAMMER HOG

### Spiral Efficient Design

- The steel hammers in a Montgomery Hammer Hog are individually pinned between supporting rings and arranged in a spiral cut pattern.
- The spiral design assures steady and distributed impact, lessening the shock load on the motor as material enters the hog.
- High volumes can be processed using less horsepower than would be typically required using a traditional through rod design.
- The configuration is geometrically balanced to support stable operation and reduce the starting load on the motor during startup.
- Flywheels on both ends act to store rotational energy and function as seals to prevent binding of material against housing endplates.
- Hammers are available in a variety of profiles and materials, including a removable insert design with severe abrasion hardsurfacing (shown).

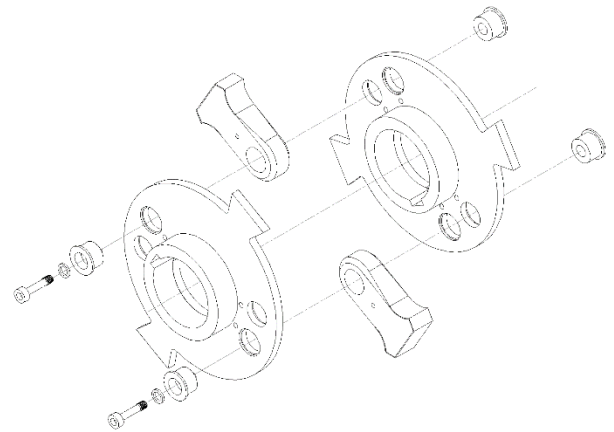

Montgomery Industries International, Inc.  
P.O. Box 3687 2017 Thelma St.  
Jacksonville, Florida U.S.A. 32206  
Phone: 904-355-5671 Fax: 904-355-0401



# THE HH36 SERIES

## SPIRAL DESIGN – SWINGHAMMER HOG

### Sectional Screens

- When grinding bark for hogged fuel and for other coarse breakdown applications, a three-section box-type welded steel screen is typically used to endure the pummeling of material across the screen.
- Heavy rolled steel plate with a variety of sizing hole options can also be used as an alternative method of screening.
- Hardsurfacing is applied to the leading edges and cutting surfaces to increase durability and economic life.
- The three screen sections are interchangeable so that only a section that is worn need be replaced. The screen sections can be removed through access doors on either side of the hog.

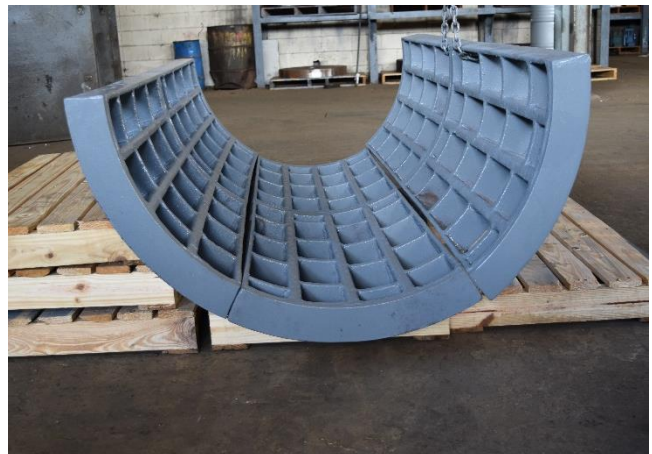

Montgomery Industries International, Inc.  
P.O. Box 3687 2017 Thelma St.  
Jacksonville, Florida U.S.A. 32206  
Phone: 904-355-5671 Fax: 904-355-0401



# THE HH36 SERIES

## SPIRAL DESIGN – SWINGHAMMER HOG

### Easy Access for Maintenance

Front and rear access doors enable prompt inspection and servicing of the hog. Reaching the individually pinned hammers, sizing screens, and replaceable wear liners in the cutting chamber is made easy with swinging barn doors on the rear of the machine and optional hydraulic opener on the front.



Montgomery Industries International, Inc.  
P.O. Box 3687 2017 Thelma St.  
Jacksonville, Florida U.S.A. 32206  
Phone: 904-355-5671 Fax: 904-355-0401



# THE HH36 SERIES

## SPIRAL DESIGN – SWINGHAMMER HOG

### HH36

- Typical applications include bark and the coarse reduction of solids such as yard trash or construction debris.
- HH36 rings with individually pinned hammers provide a 36" cutting circle.
- Rotor assembly incorporates two 3" X 23" steel flywheels for rotational momentum and to prevent material from binding against housing end plates.



#### **Bark Processing Capacity:**

Up to 70 tons per hour

#### **Power Requirements:**

150 hp – 400 hp

#### **Optional Sizes:**

27" – 36" – 44" – 53" – 61" – 70"

#### **Cutting Circle:**

36" Diameter

Montgomery Industries International, Inc.  
P.O. Box 3687 2017 Thelma St.  
Jacksonville, Florida U.S.A. 32206  
Phone: 904-355-5671 Fax: 904-355-0401